

# SCHEDULE "A"

## PROPOSED SUBDIVISION PLAN

1384555 BC LTD.

LOT 32, SECTION 4,  
RANGE 4, WELLINGTON  
DISTRICT, PLAN 21691

ADDRESS : 5515 GODFREY ROAD,  
NANAIMO, B.C.

PROJECT SURVEYOR : D.W. HOLME

DRAWN BY : DWH      DATE : DEC. 18/24

OUR FILE : 90733      REVISION :



1A - 3411 SHENTON ROAD, NANAIMO, B.C. V9T 2H1  
TEL: 250-758-4631 FAX: 250-758-4660  
E-MAIL : nanaimo@jeanderson.com  
NANAIMO - VICTORIA - PARKSVILLE - CAMPBELL RIVER

### LEGEND

ALL DIMENSIONS ARE IN METRES

SUBJECT TO CHARGES SHOWN  
ON TITLE NO. CB1171949  
(P.I.D. 000-987-166)

DIMENSIONS ARE DERIVED FROM  
LAND TITLE OFFICE RECORDS

THIS PLAN HAS BEEN PREPARED IN  
ACCORDANCE WITH THE PROFESSIONAL  
REFERENCE MANUAL

CITY OF NANAIMO

PRELIMINARY LAYOUT ACCEPTANCE

2025-MAR-19

Date

Approved By

Expiry Date: 2026-MAR-19



The intended plot size of this plan is 432mm in width by 280mm in height (B size) when plotted at a scale of 1:250



BURNHAM CRESCENT

GODFREY ROAD

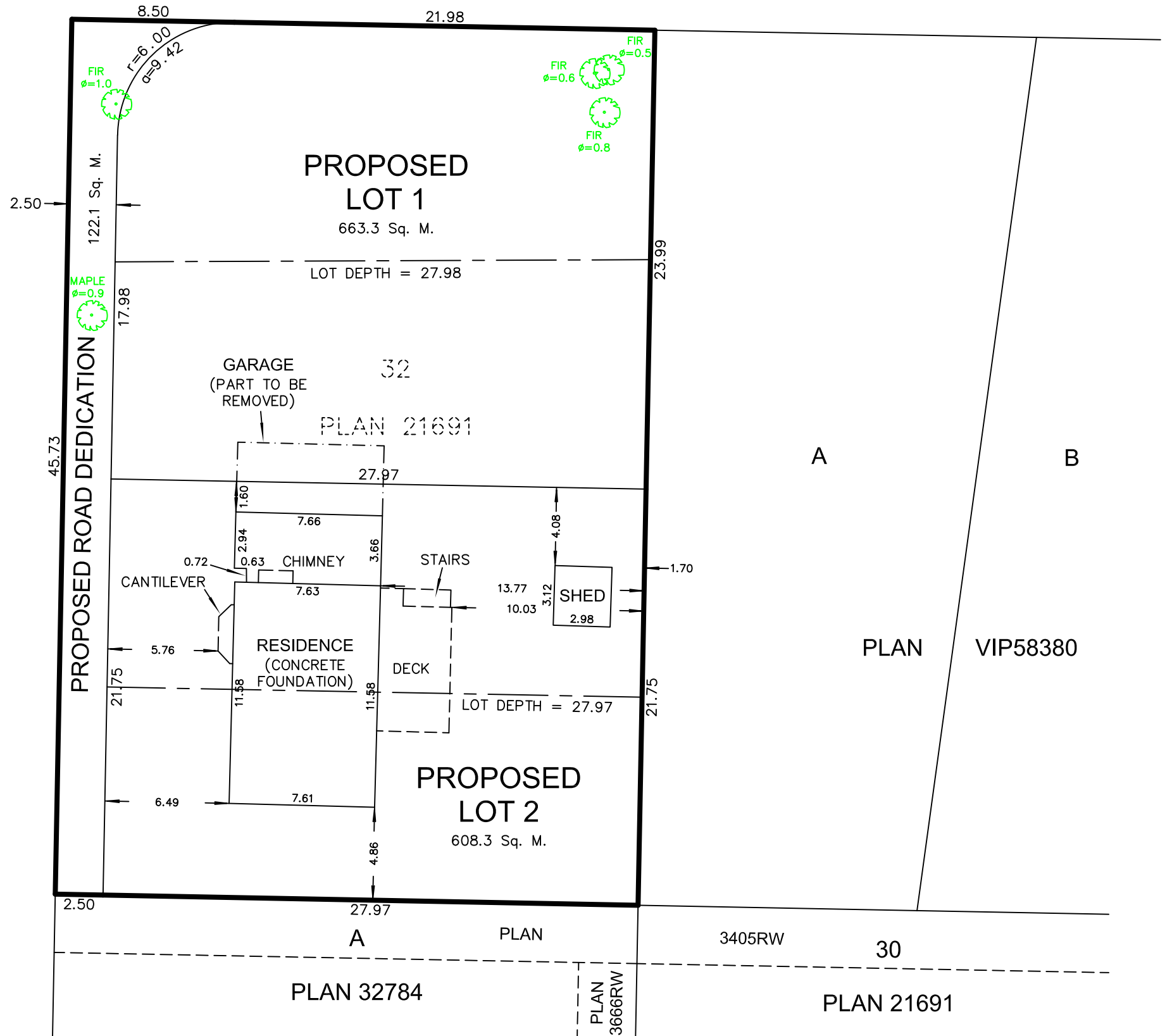

A

B

PLAN VIP58380

PLAN 32784

PLAN 3666RW

PLAN 21691

3405RW

30

PROPOSED LOT 1  
663.3 Sq. M.

32  
PLAN 21691

PROPOSED LOT 2  
608.3 Sq. M.

A

PLAN

LOT DEPTH = 27.98

LOT DEPTH = 27.97

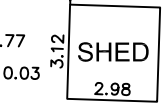
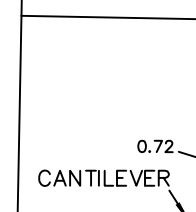
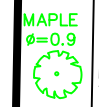
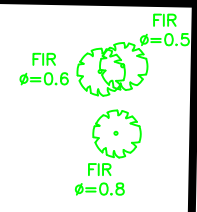
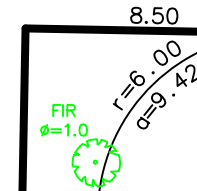

GARAGE  
(PART TO BE  
REMOVED)

CHIMNEY

STAIRS

SHED

RESIDENCE  
(CONCRETE  
FOUNDATION)

DECK

CANTILEVER

PROPOSED ROAD DEDICATION

122.1 Sq. M.

45.73

2.50

27.97

21.98

23.99

21.75

8.50

2.50

17.98

27.97

21.75

2.50

27.97

21.75

8.50

2.50

17.98

27.97

21.75

2.50

27.97

21.75